

**NEW
2022**



**MINIDUMPER WITH HIGH-TIP AND
SELF-LOADING DUMPER BED**

DIESEL ENGINE

Model Kubota D902-E3B stage V
Emission regulation.... EPA 4 Tier
Type.....Vertical 4-cycle Liquid cooled Diesel
Number of Cylinders... 3
Displacement.....898 cm³
Power SAEJ1349.....16,1 Kw (21,6CV)/3200rpm
Fuel tank.....20 lt

Inferior track rollers..... 3 fix rollers each side
Superior track slide..... 1 each side
Fixed undercarriage.....990 mm

TRACKS

Track tensioner.....grease
Track width.....230 mm

PERFORMANCE

Capacity..... 1040 kg
Travel speed front/rear:
1st speed..... 0-2,3 km/h
2nd speed..... 0-3,8 km/h
Dumper bed capacity.... 0,52 m³
Estimated Weight (empty)...1280 kg

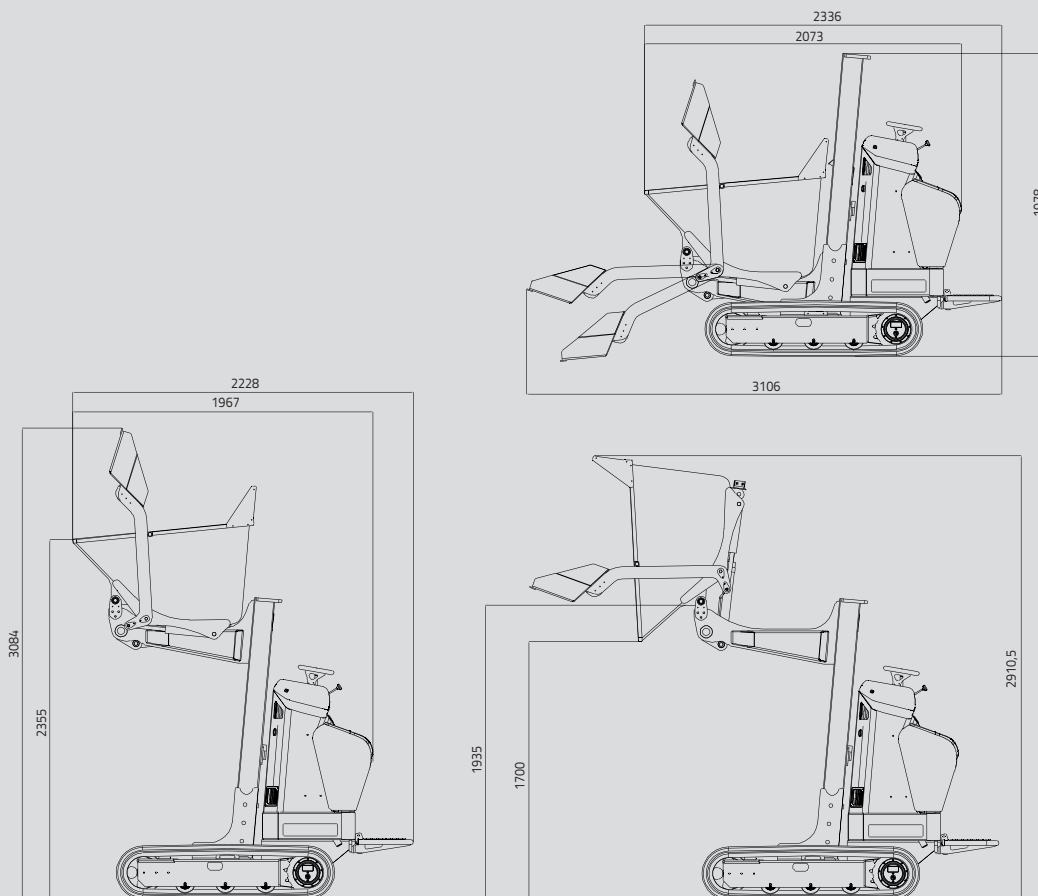

HINOWA is continually researching and developing products and reserves the right to make modifications without prior notice. All data in this document is indicative. Certain options or country standards will increase weight. Specifications may change to meet country standards or with the addition of optional equipment.